

ATTACHMENT E
AGRICULTURAL DATA STATEMENT

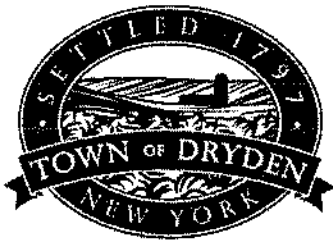

Planning Department

93 East Main Street
Dryden, NY 13053

T 607 844-8888 ext. 216
F 607 844-8008
joy@dryden.ny.us

<http://dryden.ny.us/planning-department>

AGRICULTURAL DATA STATEMENT

(Pursuant to Section 305-a of the NYS Agriculture and Markets Law)

Application:

- Special Use Permit
- Site Plan Review
- Use Variance
- Subdivision approval

Applicants must submit an Agricultural Data Statement (ADS) if the proposed project occurs on a parcel within Tompkins County Agricultural District #1 or on a parcel the boundaries of which are within 500 feet of a farm operation located within an agricultural district.

Content of an Agricultural Data Statement requires:

- Name and address of applicant,
- Description of the proposed project and its location,
- Name and address of any owner of land within the agricultural district, which land contains farm operations and is located within 500 feet of the boundaries of the property upon which the project is proposed,
- A tax map or other map showing the site of the proposed project relative to the location of the farm operations identified in the ADS.

The Town of Dryden is required to mail a written notice containing a description of the proposed project and its location to owners of land identified in the Agricultural Data Statement.

The local reviewing board (Town, Planning, ZBA, Village etc.) must evaluate and consider the Agricultural Data Statement to determine the possible impacts the proposed project may have on the functioning of farm operations.

Procedure

A map of the town's agricultural district(s) is available in the Planning Department office, and on the town and county websites.

The board will review the project in relation to current and future farming conditions to ensure the proposed land use does not conflict with current or future farming activities.

The Tompkins County Agricultural and Farmland Protection Board may assist local boards in project evaluation. Members of the Board include the County Planning Director, a County Cooperative Extension Agent and the Chair of the County Soil and Water Conservation District's Board of Directors.

A copy of the completed ADS and action by the local reviewing board will be submitted to the County Agricultural and Farmland Protection Board for its records.

AGRICULTURAL DATA STATEMENT

1. Permit Application Sheet 1, General Information.

Applicant: Delaware River Solar, LLC
Address: 33 Irving Place, Suite 1090
New York, NY 10003
Phone: 646-998-6495
E-Mail: peter.dolgos@delawareriversolar.com

Project Location: Dryden Road
Dryden, NY 13053
Tax ID: 47.-1-7.3

Project Location and Description: Project site is on south side of Dryden Road between George Rd and Springhouse Rd. The project is a proposed 4MWac photovoltaic solar facility that is expected to be located on approximately 30 acres of the 135.21 acres that comprise the tax parcel.

2. Permit Application Sheet 2, Site Plan Worksheet. See Attached

3. Name, address, telephone number and type of farm of owner(s) of land within the agricultural district which land contains farm operation(s) and upon which the project is proposed or which is located within 500 feet of the boundary of the property upon which the project is proposed:

A. Name: Gabriel and Penelope Carpenter
Address: Tax ID: 47.-1-7.4 Dryden Road, Dryden NY 13503
Phone#: _____
Type of farm: Field Crops

B. Name: Paul and Betty Cook
Address: Tax ID: 47.-1-3.2 Dryden Road, Dryden NY 13503
Phone#: _____
Type of farm: Dairy

C. Name: Hugh A. Jonas
Address: Tax ID: 47.-1-10.1
Phone#: _____
Type of farm: Field Crops

D. Name: Evan and Brenda Carpenter
Address: Tax ID: 19.-1-1 Ferguson Road, Dryden NY 13503
Phone#: _____
Type of farm: Field Crops

E. Name: Warren and Barbara Van Pelt
Address: Tax ID: 38.-1-18.22 Dryden Road, Dryden NY 13503
Phone#: _____
Type of farm: Field Crops

F. Name: Maryhill Farm, LLC
Address: Tax ID: 47.-1-23.2 Ferguson Road, Dryden NY 13503
Phone#: _____
Type of farm: Field Crops

4. Site Plan Worksheet showing relation to farm. See attached



Planning Department

Director of Planning
Code Enforcement Officer
Code Enforcement Officer
Senior Planner

Administrative Coordinator

Jane Nicholson
Kevin Ezell
David Sprout
Jane Nicholson

Joy Foster

93 East Main Street
Dryden, NY 13053

T 607 844-8888 Ext. 216
F 607 844-8008
joy@dryden.ny.us

www.dryden.ny.us

General Permit Application – Sheet 1 General Information

DO NOT FILL IN SHADED SECTIONS

June 21, 2017 47.-1-7.3 Rural Agricultural
Date: Tax Parcel #: Zoning District:
(Complete) Project
Address: Dryden Road, Dryden NY, 13053

Project Description: The installation and operation of two (2) separate 2MW ac (approximate) photovoltaic solar facilities that will be adjacent to each other. If interconnection regulations change, the two (2) separate 2MW (approximate) facilities may become a single 4 MM ac (approximate) facility where the footprint-layout would not be expected to increase and would likely decrease due to single interconnection point.

Estimated project cost: \$6,500,000

Principal Use: Residential _____ Commercial: _____ Other: solar facility

Permit(s) Required: Building Zoning Special Use Site Plan Review Subdivision Pool
 Heating Demolition Pre-built Shed

To be completed by Planning Department personnel:

Worksheets / sections required:

- | | |
|---|---|
| <input type="checkbox"/> Site Plan Sketch Fee : \$250 | <input type="checkbox"/> Driveway or Roadcut Compliance |
| <input type="checkbox"/> Site Plan Review (See Fee Schedule) | <input type="checkbox"/> Notices and Disclaimer Acknowledgement |
| <input type="checkbox"/> Special Use Permit (See Fee Schedule) | <input type="checkbox"/> Agricultural Data Statement |
| <input type="checkbox"/> Notice of Ground Disturbance | <input type="checkbox"/> County Review |
| <input type="checkbox"/> Zoning Permit Fee : \$25 | <input type="checkbox"/> Minor Subdivision Fee : \$25 |
| <input type="checkbox"/> Varna Compliance Worksheet | <input type="checkbox"/> Major Subdivision (See Fee Schedule) |
| <input type="checkbox"/> Residential Design Guidelines Compliance | <input type="checkbox"/> Demolition |
| <input type="checkbox"/> Commercial Design Guidelines Compliance | <input type="checkbox"/> Lot Line Adjustment |
| <input type="checkbox"/> Sign Compliance Worksheet | |

Notes:

Permit Application - Contact Information

Owner - Print name: Evan and Brenda Carpenter

Owner Signature required & dated:  dated: 6-23-17

Address: Dryden Road (Tax ID: 47-1-7.3) City: Dryden State: NY Zip Code: 13053

E-mail: _____ Telephone No.: _____

Emergency Contact: _____ Telephone No.: _____

Agent / Applicant - Print : Delaware River Solar, LLC

Address: 33 Irving Place, Suite 1090 City: New York State: NY Zip Code: 13053

E-mail: peter.dolgos@delawareriversolar.com Telephone No: 646-998-6495

General Contractor: TBD License # _____

Address: _____ City: _____ State: _____ Zip Code: _____

E-mail: _____ Telephone No: _____

Mason Contractor: not applicable License # _____

Address: _____ City: _____ State: _____ Zip Code: _____

E-mail: _____ Telephone No: _____

Electrical Contractor: TBD License # _____

Address: _____ City: _____ State: _____ Zip Code: _____

E-mail: _____ Telephone No: _____

HVAC Contractor: not applicable License # _____

Address: _____ City: _____ State: _____ Zip Code: _____

E-mail: _____ Telephone No: _____

Plumbing Contractor: not applicable License # _____

Address: _____ City: _____ State: _____ Zip Code: _____

E-mail: _____ Telephone No: _____

Surveyor: Kaatskill Mountain Surveyors License # 050393

Address: 23 Maple Street City: Oneonta State: NY Zip Code: 13820

E-mail: kmssurvey@kmssurvey.com Telephone No: 607-433-2692

Note: The Town of Dryden will keep your contact information private.

**CUT: _____ **

Application from _____ for _____

Project Site _____ received on _____

Payment received \$ _____ Cash _____ Check # _____ Credit Card (circle one) _____

Signature of receiver _____ Date _____

NEW YORK STATE DEPARTMENT OF ENVIRONMENTAL CONSERVATION

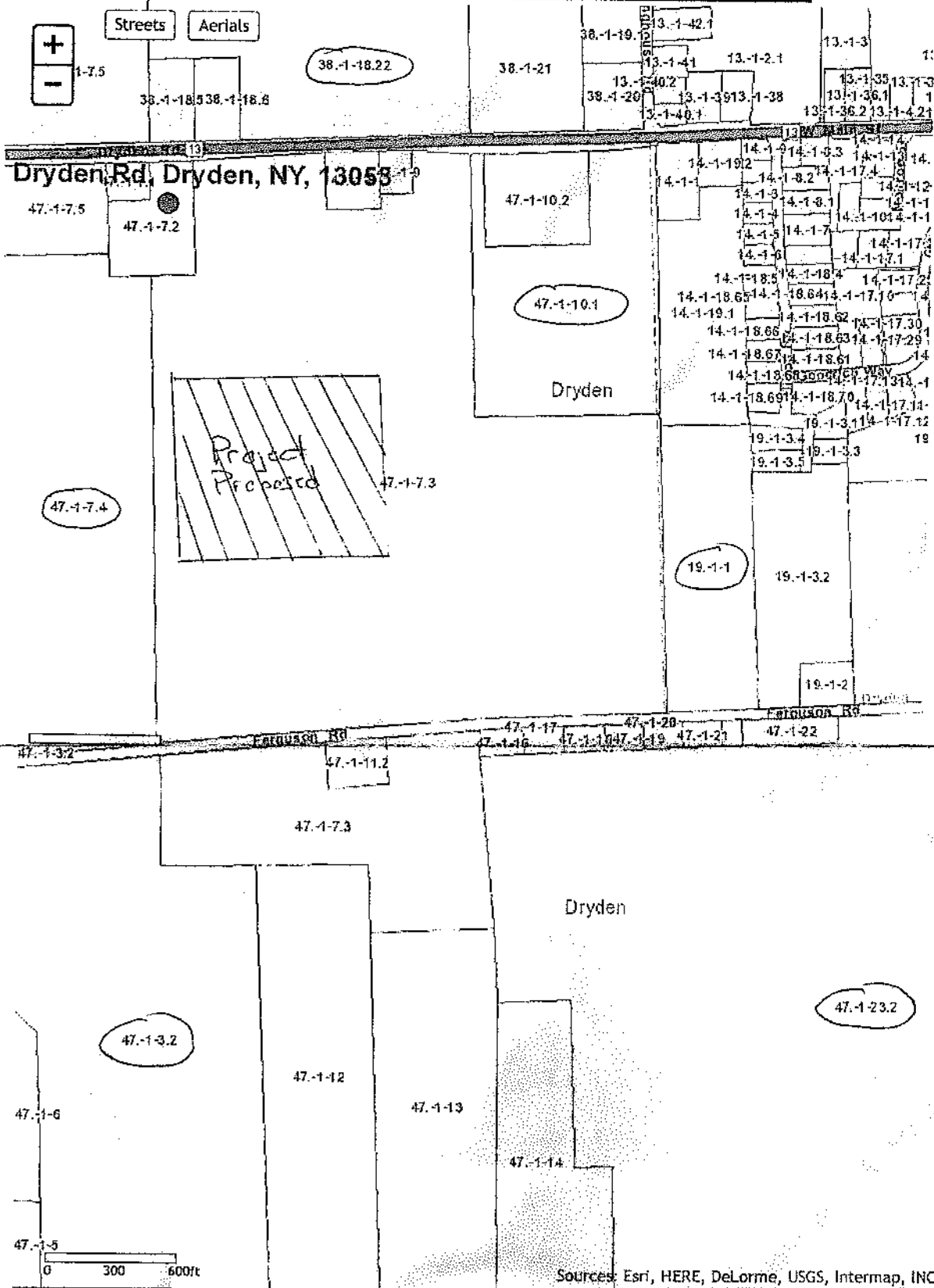

○ circled tax ids are active farms
 ▨ represents proposed project site