

**Full Environmental Assessment Form
Part 1 - Project and Setting**

Instructions for Completing Part 1

Part 1 is to be completed by the applicant or project sponsor. Responses become part of the application for approval or funding, are subject to public review, and may be subject to further verification.

Complete Part 1 based on information currently available. If additional research or investigation would be needed to fully respond to any item, please answer as thoroughly as possible based on current information; indicate whether missing information does not exist, or is not reasonably available to the sponsor; and, when possible, generally describe work or studies which would be necessary to update or fully develop that information.

Applicants/sponsors must complete all items in Sections A & B. In Sections C, D & E, most items contain an initial question that must be answered either “Yes” or “No”. If the answer to the initial question is “Yes”, complete the sub-questions that follow. If the answer to the initial question is “No”, proceed to the next question. Section F allows the project sponsor to identify and attach any additional information. Section G requires the name and signature of the applicant or project sponsor to verify that the information contained in Part 1 is accurate and complete.

A. Project and Applicant/Sponsor Information.

Name of Action or Project: Maiffly Development - 5 & 9 Freese Road		
Project Location (describe, and attach a general location map): Northwest of Freese Road and NYS Route 366 (Dryden Road) intersection.		
Brief Description of Proposed Action (include purpose or need): This project proposes the demolition of the existing building and gravel driveways to facilitate the construction of four (4) new buildings to provide multi-family housing totaling 32 dwelling units (64 bedrooms) on Tax ID's 53.-1-3.2 & 53.-1-3.7 and associated site, access, parking, grading, lighting, landscaping, stormwater and utility improvements. In addition, site plan amendment for a previously approved project (aka "The Cottages at Fall Creek Crossing) consisting of 15 single-family homes (10 3-bedroom & 5 2-bedroom units) proposed on Tax ID's 53.1-1-1, 53.1-1-2, 53.1-1-3, 53.1-1-4, 53.1-1-5, 53.1-1-6, 53.1-1-7, 53.1-1-8, 53.1-1-9, 53.1-1-10, 53.1-1-11, 53.1-1-12, 53.1-1-13, 53.1-1-14, 53.1-1-15, & 53.1-1-16 and associated site, access, parking, lighting, landscaping, stormwater and utility improvements. Site plan amendments include the addition of a +/-1,000 SF community building as well as minor parking, landscaping, utility and grading improvement changes.		
Name of Applicant/Sponsor: Maiffly Development - Matt Durbin	Telephone: (412) 770-4595	E-Mail: mdurbin@maifflydevelopment.com
Address: 2400 Oxford Drive Suite #411		
City/PO: Pittsburgh	State: PA	Zip Code: 15210
Project Contact (if not same as sponsor; give name and title/role): Adam Fishel, PE, CPESC	Telephone: (604) 241-2917	E-Mail: afishel@marathoneng.com
Address: 840 Hanshaw Road Suite #12		
City/PO: Adam Fishel	State: NY	Zip Code: 14850
Property Owner (if not same as sponsor):	Telephone:	E-Mail:
Address:		
City/PO:	State:	Zip Code:

B. Government Approvals

B. Government Approvals, Funding, or Sponsorship. (“Funding” includes grants, loans, tax relief, and any other forms of financial assistance.)

Government Entity	If Yes: Identify Agency and Approval(s) Required	Application Date (Actual or projected)
a. City Counsel, Town Board, <input type="checkbox"/> Yes <input checked="" type="checkbox"/> No or Village Board of Trustees		
b. City, Town or Village Planning Board or Commission <input checked="" type="checkbox"/> Yes <input type="checkbox"/> No	Dryden Planning Board - Site Plan Review & Lot line change.	3/12/20 - Actual
c. City, Town or Village Zoning Board of Appeals <input type="checkbox"/> Yes <input checked="" type="checkbox"/> No		
d. Other local agencies <input checked="" type="checkbox"/> Yes <input type="checkbox"/> No	Dryden Building Permit, Dryden Highway Department for Driveway Permit	TBD
e. County agencies <input checked="" type="checkbox"/> Yes <input type="checkbox"/> No	DOH-Backflow, County Planning - 239M/N	Backflow-TBD, 239M/N- TBD by town
f. Regional agencies <input type="checkbox"/> Yes <input checked="" type="checkbox"/> No		
g. State agencies <input checked="" type="checkbox"/> Yes <input type="checkbox"/> No	NYSDEC GP-0-20-001, NYSDEC- Water/Sewer Extension, NYSDOT - ROW work permit	TBD
h. Federal agencies <input type="checkbox"/> Yes <input checked="" type="checkbox"/> No		
i. Coastal Resources. i. Is the project site within a Coastal Area, or the waterfront area of a Designated Inland Waterway? <input type="checkbox"/> Yes <input checked="" type="checkbox"/> No ii. Is the project site located in a community with an approved Local Waterfront Revitalization Program? <input type="checkbox"/> Yes <input checked="" type="checkbox"/> No iii. Is the project site within a Coastal Erosion Hazard Area? <input type="checkbox"/> Yes <input checked="" type="checkbox"/> No		

C. Planning and Zoning

C.1. Planning and zoning actions.

Will administrative or legislative adoption, or amendment of a plan, local law, ordinance, rule or regulation be the only approval(s) which must be granted to enable the proposed action to proceed? YesNo

- If Yes, complete sections C, F and G.
- If No, proceed to question C.2 and complete all remaining sections and questions in Part 1

C.2. Adopted land use plans.

a. Do any municipally- adopted (city, town, village or county) comprehensive land use plan(s) include the site where the proposed action would be located? YesNo

If Yes, does the comprehensive plan include specific recommendations for the site where the proposed action would be located? YesNo

b. Is the site of the proposed action within any local or regional special planning district (for example: Greenway; Brownfield Opportunity Area (BOA); designated State or Federal heritage area; watershed management plan; or other?) YesNo

If Yes, identify the plan(s):

Hamlet of Varna _____

c. Is the proposed action located wholly or partially within an area listed in an adopted municipal open space plan, or an adopted municipal farmland protection plan? YesNo

If Yes, identify the plan(s):

C.3. Zoning

a. Is the site of the proposed action located in a municipality with an adopted zoning law or ordinance. Yes No
If Yes, what is the zoning classification(s) including any applicable overlay district?
Varna Hamlet Mixed Use District

b. Is the use permitted or allowed by a special or conditional use permit? Yes No

c. Is a zoning change requested as part of the proposed action? Yes No
If Yes,
i. What is the proposed new zoning for the site? _____

C.4. Existing community services.

a. In what school district is the project site located? Ithaca City School District

b. What police or other public protection forces serve the project site?
Tompkins County Sheriff & NYS Police

c. Which fire protection and emergency medical services serve the project site?
Varna and Dryden Fire Department

d. What parks serve the project site?
Cornell Botanical Gardens, Cayuga Lake Nature Trail, Monkey Run Natural Area, Sapsucker Woods

D. Project Details

D.1. Proposed and Potential Development

a. What is the general nature of the proposed action (e.g., residential, industrial, commercial, recreational; if mixed, include all components)? Multi-family Residential

b. a. Total acreage of the site of the proposed action? _____ ±4.7 acres
b. Total acreage to be physically disturbed? _____ ±4.3 acres
c. Total acreage (project site and any contiguous properties) owned or controlled by the applicant or project sponsor? _____ ±4.7 acres

c. Is the proposed action an expansion of an existing project or use? Yes No
i. If Yes, what is the approximate percentage of the proposed expansion and identify the units (e.g., acres, miles, housing units, square feet)? % _____ Units: _____

d. Is the proposed action a subdivision, or does it include a subdivision? Yes No
If Yes, **Tax ID's 53.-1-3.2 & 53.-1-3.7 will be combined via lot line adjustment review/approval by the Town of Dryden**
i. Purpose or type of subdivision? (e.g., residential, industrial, commercial; if mixed, specify types)
Residential
ii. Is a cluster/conservation layout proposed? **No changes are proposed to the original Cluster Subdivision** Yes No
iii. Number of lots proposed? _____ **associated with 5 Freese Road**
iv. Minimum and maximum proposed lot sizes? Minimum _____ Maximum _____

e. Will the proposed action be constructed in multiple phases? Yes No
i. If No, anticipated period of construction: _____ ±12 months
ii. If Yes:
• Total number of phases anticipated _____
• Anticipated commencement date of phase 1 (including demolition) _____ month _____ year
• Anticipated completion date of final phase _____ month _____ year
• Generally describe connections or relationships among phases, including any contingencies where progress of one phase may determine timing or duration of future phases: _____

f. Does the project include new residential uses? Yes No
 If Yes, show numbers of units proposed.

	<u>One Family</u>	<u>Two Family</u>	<u>Three Family</u>	<u>Multiple Family (four or more)</u>
Initial Phase	15 units total			32 units, 64 bedrooms total
At completion	(5 2-bedroom units &			
of all phases	10 3-bedroom units)			32 units, 64 bedrooms total

g. Does the proposed action include new non-residential construction (including expansions)? Yes No
 If Yes, Community building

i. Total number of structures 1
 ii. Dimensions (in feet) of largest proposed structure: +/-25' height; +/-25' width; and +/-40' length
 iii. Approximate extent of building space to be heated or cooled: 1,000 square feet

h. Does the proposed action include construction or other activities that will result in the impoundment of any liquids, such as creation of a water supply, reservoir, pond, lake, waste lagoon or other storage? Yes No
 If Yes,

i. Purpose of the impoundment: _____
 ii. If a water impoundment, the principal source of the water: Ground water Surface water streams Other specify: _____
 iii. If other than water, identify the type of impounded/contained liquids and their source. _____
 iv. Approximate size of the proposed impoundment. Volume: _____ million gallons; surface area: _____ acres
 v. Dimensions of the proposed dam or impounding structure: _____ height; _____ length
 vi. Construction method/materials for the proposed dam or impounding structure (e.g., earth fill, rock, wood, concrete): _____

D.2. Project Operations

a. Does the proposed action include any excavation, mining, or dredging, during construction, operations, or both? Yes No
 (Not including general site preparation, grading or installation of utilities or foundations where all excavated materials will remain onsite) Excavations are anticipated to be limited to general site grading and installation of utilities or foundations.
 If Yes:

i. What is the purpose of the excavation or dredging? _____
 ii. How much material (including rock, earth, sediments, etc.) is proposed to be removed from the site?
 • Volume (specify tons or cubic yards): _____
 • Over what duration of time? _____
 iii. Describe nature and characteristics of materials to be excavated or dredged, and plans to use, manage or dispose of them. _____

 iv. Will there be onsite dewatering or processing of excavated materials? Yes No
 If yes, describe. _____

 v. What is the total area to be dredged or excavated? _____ acres
 vi. What is the maximum area to be worked at any one time? _____ acres
 vii. What would be the maximum depth of excavation or dredging? _____ feet
 viii. Will the excavation require blasting? Yes No
 ix. Summarize site reclamation goals and plan: _____

b. Would the proposed action cause or result in alteration of, increase or decrease in size of, or encroachment into any existing wetland, waterbody, shoreline, beach or adjacent area? Yes No
 If Yes:

i. Identify the wetland or waterbody which would be affected (by name, water index number, wetland map number or geographic description): _____

ii. Describe how the proposed action would affect that waterbody or wetland, e.g. excavation, fill, placement of structures, or alteration of channels, banks and shorelines. Indicate extent of activities, alterations and additions in square feet or acres:

iii. Will the proposed action cause or result in disturbance to bottom sediments? Yes No

If Yes, describe: _____

iv. Will the proposed action cause or result in the destruction or removal of aquatic vegetation? Yes No

If Yes:

- acres of aquatic vegetation proposed to be removed: _____
- expected acreage of aquatic vegetation remaining after project completion: _____
- purpose of proposed removal (e.g. beach clearing, invasive species control, boat access): _____
- proposed method of plant removal: _____
- if chemical/herbicide treatment will be used, specify product(s): _____

v. Describe any proposed reclamation/mitigation following disturbance: _____

c. Will the proposed action use, or create a new demand for water? Yes No

If Yes:

i. Total anticipated water usage/demand per day: _____ ±11,440 gallons/day

ii. Will the proposed action obtain water from an existing public water supply? Yes No

If Yes:

- Name of district or service area: W2424- Varna Wtr FF serviced by Southern Cayuga Lake Intermunicipal Water Commission
- Does the existing public water supply have capacity to serve the proposal? Yes No
- Is the project site in the existing district? Yes No
- Is expansion of the district needed? Yes No
- Do existing lines serve the project site? Yes No

iii. Will line extension within an existing district be necessary to supply the project? Yes No

If Yes:

- Describe extensions or capacity expansions proposed to serve this project: _____
- Source(s) of supply for the district: _____

iv. Is a new water supply district or service area proposed to be formed to serve the project site? Yes No

If Yes:

- Applicant/sponsor for new district: _____
- Date application submitted or anticipated: _____
- Proposed source(s) of supply for new district: _____

v. If a public water supply will not be used, describe plans to provide water supply for the project: _____

vi. If water supply will be from wells (public or private), what is the maximum pumping capacity: _____ gallons/minute.

d. Will the proposed action generate liquid wastes? Yes No

See notes at end of document.

If Yes:

i. Total anticipated liquid waste generation per day: _____ ±11,440 gallons/day

ii. Nature of liquid wastes to be generated (e.g., sanitary wastewater, industrial; if combination, describe all components and approximate volumes or proportions of each): _____

Sanitary wastewater

iii. Will the proposed action use any existing public wastewater treatment facilities? Yes No

If Yes:

- Name of wastewater treatment plant to be used: Ithaca Area Wastewater Treatment Facility
- Name of district: S2422- Varna Swr Prime
- Does the existing wastewater treatment plant have capacity to serve the project? Yes No
- Is the project site in the existing district? Yes No
- Is expansion of the district needed? Yes No

• Do existing sewer lines serve the project site? Yes No
 • Will a line extension within an existing district be necessary to serve the project? Yes No
 If Yes: An amendment to the sewer main extension previously approved by NYSDEC is proposed to better accommodate the project.

- Describe extensions or capacity expansions proposed to serve this project: _____
 Rerouting the 8" sanitary sewer main within the Freese Road/Dryden Road right of ways versus the alignment previously approved by the Town & DEC as part of the The Cottages at Fall Creek Crossing project.

iv. Will a new wastewater (sewage) treatment district be formed to serve the project site? Yes No
 If Yes:

- Applicant/sponsor for new district: _____
- Date application submitted or anticipated: _____
- What is the receiving water for the wastewater discharge? _____

v. If public facilities will not be used, describe plans to provide wastewater treatment for the project, including specifying proposed receiving water (name and classification if surface discharge or describe subsurface disposal plans):

vi. Describe any plans or designs to capture, recycle or reuse liquid waste: _____

e. Will the proposed action disturb more than one acre and create stormwater runoff, either from new point sources (i.e. ditches, pipes, swales, curbs, gutters or other concentrated flows of stormwater) or non-point source (i.e. sheet flow) during construction or post construction? Yes No
 If Yes:

i. How much impervious surface will the project create in relation to total size of project parcel?
 _____ Square feet or ±2.4 acres (impervious surface)
 _____ Square feet or ±4.7 acres (parcel size)

ii. Describe types of new point sources. Pond proposed as part of "The Cottages at Fall Creek Crossing" project will be expanded slightly to accommodate the additional runoff which will continue to discharge at the current pond outfall location.

iii. Where will the stormwater runoff be directed (i.e. on-site stormwater management facility/structures, adjacent properties, groundwater, on-site surface water or off-site surface waters)?
Directed toward previously approved on-site stormwater management facilities then onto adjacent properties and into off-site surface waters via existing off site drainage ditches.

- If to surface waters, identify receiving water bodies or wetlands: _____
 Fall Creek
- Will stormwater runoff flow to adjacent properties? Yes No

iv. Does the proposed plan minimize impervious surfaces, use pervious materials or collect and re-use stormwater? Yes No

f. Does the proposed action include, or will it use on-site, one or more sources of air emissions, including fuel combustion, waste incineration, or other processes or operations? Yes No
 If Yes, identify:

i. Mobile sources during project operations (e.g., heavy equipment, fleet or delivery vehicles)
Mobile equipment during construction

ii. Stationary sources during construction (e.g., power generation, structural heating, batch plant, crushers)
Potential stationary sources during construction (ie generators, compressors, etc)

iii. Stationary sources during operations (e.g., process emissions, large boilers, electric generation)
NA

g. Will any air emission sources named in D.2.f (above), require a NY State Air Registration, Air Facility Permit, or Federal Clean Air Act Title IV or Title V Permit? Yes No
 If Yes:

i. Is the project site located in an Air quality non-attainment area? (Area routinely or periodically fails to meet ambient air quality standards for all or some parts of the year) Yes No

ii. In addition to emissions as calculated in the application, the project will generate:

- _____ Tons/year (short tons) of Carbon Dioxide (CO₂)
- _____ Tons/year (short tons) of Nitrous Oxide (N₂O)
- _____ Tons/year (short tons) of Perfluorocarbons (PFCs)
- _____ Tons/year (short tons) of Sulfur Hexafluoride (SF₆)
- _____ Tons/year (short tons) of Carbon Dioxide equivalent of Hydroflouorocarbons (HFCs)
- _____ Tons/year (short tons) of Hazardous Air Pollutants (HAPs)

h. Will the proposed action generate or emit methane (including, but not limited to, sewage treatment plants, landfills, composting facilities)? Yes No
 If Yes:
 i. Estimate methane generation in tons/year (metric): _____
 ii. Describe any methane capture, control or elimination measures included in project design (e.g., combustion to generate heat or electricity, flaring): _____

i. Will the proposed action result in the release of air pollutants from open-air operations or processes, such as quarry or landfill operations? Yes No
 If Yes: Describe operations and nature of emissions (e.g., diesel exhaust, rock particulates/dust): _____

j. Will the proposed action result in a substantial increase in traffic above present levels or generate substantial new demand for transportation facilities or services? Yes No
Based on the trip generation data, both projects will generate approximately 8 entering/24 exiting vehicle trips during the AM peak hour and 23 entering/14 exiting vehicle trips during the PM peak hour.
 If Yes:
 i. When is the peak traffic expected (Check all that apply): Morning Evening Weekend
 Randomly between hours of _____ to _____.
 ii. For commercial activities only, projected number of truck trips/day and type (e.g., semi trailers and dump trucks): _____
 iii. Parking spaces: Existing 0 Proposed 100 Net increase/decrease 100
 iv. Does the proposed action include any shared use parking? Yes No
 v. If the proposed action includes any modification of existing roads, creation of new roads or change in existing access, describe: NA
 vi. Are public/private transportation service(s) or facilities available within 1/2 mile of the proposed site? Yes No
 vii. Will the proposed action include access to public transportation or accommodations for use of hybrid, electric or other alternative fueled vehicles? Yes No
 viii. Will the proposed action include plans for pedestrian or bicycle accommodations for connections to existing pedestrian or bicycle routes? Yes No

k. Will the proposed action (for commercial or industrial projects only) generate new or additional demand for energy? Yes No
 If Yes:
 i. Estimate annual electricity demand during operation of the proposed action: _____
 ii. Anticipated sources/suppliers of electricity for the project (e.g., on-site combustion, on-site renewable, via grid/local utility, or other): _____
 iii. Will the proposed action require a new, or an upgrade, to an existing substation? Yes No

l. Hours of operation. Answer all items which apply.

<p>i. During Construction:</p> <ul style="list-style-type: none"> • Monday - Friday: <u>as allowed by the Town of Dryden</u> • Saturday: <u>as allowed by the Town of Dryden</u> • Sunday: <u>as allowed by the Town of Dryden</u> • Holidays: <u>as allowed by the Town of Dryden</u> 	<p>ii. During Operations:</p> <ul style="list-style-type: none"> • Monday - Friday: <u>residential 24hrs/day</u> • Saturday: <u>residential 24hrs/day</u> • Sunday: <u>residential 24hrs/day</u> • Holidays: <u>residential 24hrs/day</u>
--	---

m. Will the proposed action produce noise that will exceed existing ambient noise levels during construction, operation, or both? Yes No
 If yes:
 i. Provide details including sources, time of day and duration:
 Construction equipment operation, deliveries, etc. during allowable construction hours. _____

ii. Will the proposed action remove existing natural barriers that could act as a noise barrier or screen? Yes No
 Describe: _____

n. Will the proposed action have outdoor lighting? Yes No
 If yes:
 i. Describe source(s), location(s), height of fixture(s), direction/aim, and proximity to nearest occupied structures:
 LED and Dark sky compliant fixtures _____

ii. Will proposed action remove existing natural barriers that could act as a light barrier or screen? Yes No
 Describe: _____

o. Does the proposed action have the potential to produce odors for more than one hour per day? Yes No
 If Yes, describe possible sources, potential frequency and duration of odor emissions, and proximity to nearest occupied structures: _____

p. Will the proposed action include any bulk storage of petroleum (combined capacity of over 1,100 gallons) or chemical products 185 gallons in above ground storage or any amount in underground storage? Yes No
 If Yes:
 i. Product(s) to be stored _____
 ii. Volume(s) _____ per unit time _____ (e.g., month, year)
 iii. Generally, describe the proposed storage facilities: _____

q. Will the proposed action (commercial, industrial and recreational projects only) use pesticides (i.e., herbicides, insecticides) during construction or operation? Yes No
 If Yes:
 i. Describe proposed treatment(s):

ii. Will the proposed action use Integrated Pest Management Practices? Yes No

r. Will the proposed action (commercial or industrial projects only) involve or require the management or disposal of solid waste (excluding hazardous materials)? Yes No
 If Yes:
 i. Describe any solid waste(s) to be generated during construction or operation of the facility:
 • Construction: _____ tons per _____ (unit of time)
 • Operation : _____ tons per _____ (unit of time)
 ii. Describe any proposals for on-site minimization, recycling or reuse of materials to avoid disposal as solid waste:
 • Construction: _____

 • Operation: _____

iii. Proposed disposal methods/facilities for solid waste generated on-site:
 • Construction: _____

 • Operation: _____

s. Does the proposed action include construction or modification of a solid waste management facility? Yes No

If Yes:

i. Type of management or handling of waste proposed for the site (e.g., recycling or transfer station, composting, landfill, or other disposal activities): _____

ii. Anticipated rate of disposal/processing:

- _____ Tons/month, if transfer or other non-combustion/thermal treatment, or
- _____ Tons/hour, if combustion or thermal treatment

iii. If landfill, anticipated site life: _____ years

t. Will the proposed action at the site involve the commercial generation, treatment, storage, or disposal of hazardous waste? Yes No

If Yes:

i. Name(s) of all hazardous wastes or constituents to be generated, handled or managed at facility: _____

ii. Generally describe processes or activities involving hazardous wastes or constituents: _____

iii. Specify amount to be handled or generated _____ tons/month

iv. Describe any proposals for on-site minimization, recycling or reuse of hazardous constituents: _____

v. Will any hazardous wastes be disposed at an existing offsite hazardous waste facility? Yes No

If Yes: provide name and location of facility: _____

If No: describe proposed management of any hazardous wastes which will not be sent to a hazardous waste facility: _____

E. Site and Setting of Proposed Action

E.1. Land uses on and surrounding the project site

a. Existing land uses.

i. Check all uses that occur on, adjoining and near the project site.

Urban Industrial Commercial Residential (suburban) Rural (non-farm)

Forest Agriculture Aquatic Other (specify): _____

ii. If mix of uses, generally describe: _____

b. Land uses and covertypes on the project site.

Land use or Covertypes	Current Acreage	Acreage After Project Completion	Change (Acres +/-)
• Roads, buildings, and other paved or impervious surfaces	±0.30	±2.4	+2.1
• Forested	0	0	0
• Meadows, grasslands or brushlands (non-agricultural, including abandoned agricultural)	0	0	0
• Agricultural (includes active orchards, field, greenhouse etc.)	0	0	0
• Surface water features (lakes, ponds, streams, rivers, etc.)	0	0	0
• Wetlands (freshwater or tidal)	0	0	0
• Non-vegetated (bare rock, earth or fill)	±3.75	0	-3.75
• Other Describe: <u>Lawn/Landscaped Areas</u>	±0.25	±1.9	+1.65

c. Is the project site presently used by members of the community for public recreation? Yes No
i. If Yes: explain: _____

d. Are there any facilities serving children, the elderly, people with disabilities (e.g., schools, hospitals, licensed day care centers, or group homes) within 1500 feet of the project site? Yes No
If Yes,
i. Identify Facilities: _____

e. Does the project site contain an existing dam? Yes No
If Yes:
i. Dimensions of the dam and impoundment:
• Dam height: _____ feet
• Dam length: _____ feet
• Surface area: _____ acres
• Volume impounded: _____ gallons OR acre-feet
ii. Dam's existing hazard classification: _____
iii. Provide date and summarize results of last inspection: _____

f. Has the project site ever been used as a municipal, commercial or industrial solid waste management facility, or does the project site adjoin property which is now, or was at one time, used as a solid waste management facility? Yes No
If Yes:
i. Has the facility been formally closed? Yes No
• If yes, cite sources/documentation: _____
ii. Describe the location of the project site relative to the boundaries of the solid waste management facility: _____
iii. Describe any development constraints due to the prior solid waste activities: _____

g. Have hazardous wastes been generated, treated and/or disposed of at the site, or does the project site adjoin property which is now or was at one time used to commercially treat, store and/or dispose of hazardous waste? Yes No
If Yes: The Applicant is not aware of any prior generation, treatment and/or disposal of hazardous wastes at the site.
i. Describe waste(s) handled and waste management activities, including approximate time when activities occurred: _____

h. Potential contamination history. Has there been a reported spill at the proposed project site, or have any remedial actions been conducted at or adjacent to the proposed site? Yes No
If Yes:
i. Is any portion of the site listed on the NYSDEC Spills Incidents database or Environmental Site Remediation database? Check all that apply: Yes No
 Yes – Spills Incidents database Provide DEC ID number(s): _____
 Yes – Environmental Site Remediation database Provide DEC ID number(s): _____
 Neither database
ii. If site has been subject of RCRA corrective activities, describe control measures: _____
iii. Is the project within 2000 feet of any site in the NYSDEC Environmental Site Remediation database? Yes No
If yes, provide DEC ID number(s): _____
iv. If yes to (i), (ii) or (iii) above, describe current status of site(s): _____

v. Is the project site subject to an institutional control limiting property uses? Yes No

- If yes, DEC site ID number: _____
- Describe the type of institutional control (e.g., deed restriction or easement): _____
- Describe any use limitations: _____
- Describe any engineering controls: _____
- Will the project affect the institutional or engineering controls in place? Yes No
- Explain: _____

E.2. Natural Resources On or Near Project Site

a. What is the average depth to bedrock on the project site? _____ >6 feet *According to NRCS Soils data, not considering fill placed on site.*

b. Are there bedrock outcroppings on the project site? Yes No
 If Yes, what proportion of the site is comprised of bedrock outcroppings? _____ %

c. Predominant soil type(s) present on project site:	Chenango gravelly loam	41.8 %
	Madalin mucky silty clay loam	18.9 %
	Howard gravelly loam	16.9 %

d. What is the average depth to the water table on the project site? Average: _____ >6 feet *According to NRCS Soils data, not considering fill placed on site.*

e. Drainage status of project site soils: Well Drained: 72.7 % of site
 Moderately Well Drained: 3.5 % of site
 Poorly Drained 23.8 % of site
According to NRCS Soils data, not considering fill placed on site.

f. Approximate proportion of proposed action site with slopes: 0-10%: 38.6 % of site
 10-15%: 41.8 % of site
 15% or greater: 20.6 % of site
According to NRCS Soils data, not considering fill placed on site.

g. Are there any unique geologic features on the project site? Yes No
 If Yes, describe: _____

h. Surface water features.

i. Does any portion of the project site contain wetlands or other waterbodies (including streams, rivers, ponds or lakes)? Yes No

ii. Do any wetlands or other waterbodies adjoin the project site? Yes No

If Yes to either *i* or *ii*, continue. If No, skip to E.2.i.

iii. Are any of the wetlands or waterbodies within or adjoining the project site regulated by any federal, state or local agency? Yes No

iv. For each identified regulated wetland and waterbody on the project site, provide the following information:

- Streams: Name _____ Classification _____
- Lakes or Ponds: Name _____ Classification _____
- Wetlands: Name _____ Approximate Size _____
- Wetland No. (if regulated by DEC) _____

v. Are any of the above water bodies listed in the most recent compilation of NYS water quality-impaired waterbodies? Yes No
 If yes, name of impaired water body/bodies and basis for listing as impaired: _____

i. Is the project site in a designated Floodway? Yes No

j. Is the project site in the 100-year Floodplain? Yes No

k. Is the project site in the 500-year Floodplain? Yes No

l. Is the project site located over, or immediately adjoining, a primary, principal or sole source aquifer? Yes No
 If Yes:
 i. Name of aquifer: _____

<p>m. Identify the predominant wildlife species that occupy or use the project site: _____ Deer, rabbits, rodents, various birds _____ _____</p>	
<p>n. Does the project site contain a designated significant natural community? <input type="checkbox"/> Yes <input checked="" type="checkbox"/> No If Yes: <i>i.</i> Describe the habitat/community (composition, function, and basis for designation): _____ <i>ii.</i> Source(s) of description or evaluation: _____ <i>iii.</i> Extent of community/habitat: • Currently: _____ acres • Following completion of project as proposed: _____ acres • Gain or loss (indicate + or -): _____ acres</p>	
<p>o. Does project site contain any species of plant or animal that is listed by the federal government or NYS as endangered or threatened, or does it contain any areas identified as habitat for an endangered or threatened species? <input type="checkbox"/> Yes <input checked="" type="checkbox"/> No If Yes: <i>i.</i> Species and listing (endangered or threatened): _____ _____</p>	
<p>p. Does the project site contain any species of plant or animal that is listed by NYS as rare, or as a species of special concern? <input type="checkbox"/> Yes <input checked="" type="checkbox"/> No If Yes: <i>i.</i> Species and listing: _____ _____</p>	
<p>q. Is the project site or adjoining area currently used for hunting, trapping, fishing or shell fishing? <input checked="" type="checkbox"/> Yes <input type="checkbox"/> No If yes, give a brief description of how the proposed action may affect that use: _____ The extent of hunting, trapping, fishing or shell fishing activities which may or may not take place on the project site or adjoining properties is unknown.</p>	
E.3. Designated Public Resources On or Near Project Site	
<p>a. Is the project site, or any portion of it, located in a designated agricultural district certified pursuant to Agriculture and Markets Law, Article 25-AA, Section 303 and 304? <input type="checkbox"/> Yes <input checked="" type="checkbox"/> No If Yes, provide county plus district name/number: _____</p>	
<p>b. Are agricultural lands consisting of highly productive soils present? <input type="checkbox"/> Yes <input checked="" type="checkbox"/> No <i>i.</i> If Yes: acreage(s) on project site? _____ <i>ii.</i> Source(s) of soil rating(s): _____</p>	
<p>c. Does the project site contain all or part of, or is it substantially contiguous to, a registered National Natural Landmark? <input type="checkbox"/> Yes <input checked="" type="checkbox"/> No If Yes: <i>i.</i> Nature of the natural landmark: <input type="checkbox"/> Biological Community <input type="checkbox"/> Geological Feature <i>ii.</i> Provide brief description of landmark, including values behind designation and approximate size/extent: _____ _____</p>	
<p>d. Is the project site located in or does it adjoin a state listed Critical Environmental Area? <input type="checkbox"/> Yes <input checked="" type="checkbox"/> No If Yes: <i>i.</i> CEA name: _____ <i>ii.</i> Basis for designation: _____ <i>iii.</i> Designating agency and date: _____</p>	

e. Does the project site contain, or is it substantially contiguous to, a building, archaeological site, or district which is listed on the National or State Register of Historic Places, or that has been determined by the Commissioner of the NYS Office of Parks, Recreation and Historic Preservation to be eligible for listing on the State Register of Historic Places?	<input checked="" type="checkbox"/> Yes <input type="checkbox"/> No
If Yes:	
<i>i.</i> Nature of historic/archaeological resource: <input type="checkbox"/> Archaeological Site <input checked="" type="checkbox"/> Historic Building or District	
<i>ii.</i> Name: Eligible property: Freese Road Metal Truss Bridge, Ithaca BIN 3209800	
<i>iii.</i> Brief description of attributes on which listing is based:	
Information was autopopulated by NYSDEC's online EAF mapper. The project does not propose improvements/modifications to the bridge.	
f. Is the project site, or any portion of it, located in or adjacent to an area designated as sensitive for archaeological sites on the NY State Historic Preservation Office (SHPO) archaeological site inventory?	<input type="checkbox"/> Yes <input checked="" type="checkbox"/> No
g. Have additional archaeological or historic site(s) or resources been identified on the project site?	
If Yes:	
<i>i.</i> Describe possible resource(s): _____	
<i>ii.</i> Basis for identification: _____	
h. Is the project site within five miles of any officially designated and publicly accessible federal, state, or local scenic or aesthetic resource?	<input checked="" type="checkbox"/> Yes <input type="checkbox"/> No
If Yes:	
<i>i.</i> Identify resource: Newman Arboretum, Cornell Botanical Gardens	
<i>ii.</i> Nature of, or basis for, designation (e.g., established highway overlook, state or local park, state historic trail or scenic byway, etc.): Local trails: Cayuga Trail and Dryden Rail Trail, Monkey Run Natural Area	
<i>iii.</i> Distance between project and resource: _____ <1 miles.	
i. Is the project site located within a designated river corridor under the Wild, Scenic and Recreational Rivers Program 6 NYCRR 666?	<input type="checkbox"/> Yes <input checked="" type="checkbox"/> No
If Yes:	
<i>i.</i> Identify the name of the river and its designation: _____	
<i>ii.</i> Is the activity consistent with development restrictions contained in 6NYCRR Part 666?	
<input type="checkbox"/> Yes <input type="checkbox"/> No	

F. Additional Information

Attach any additional information which may be needed to clarify your project.

If you have identified any adverse impacts which could be associated with your proposal, please describe those impacts plus any measures which you propose to avoid or minimize them.

G. Verification

I certify that the information provided is true to the best of my knowledge.

Applicant/Sponsor Name Maifly Development, LLC Date 09/08/2020

Signature  Title Managing Member

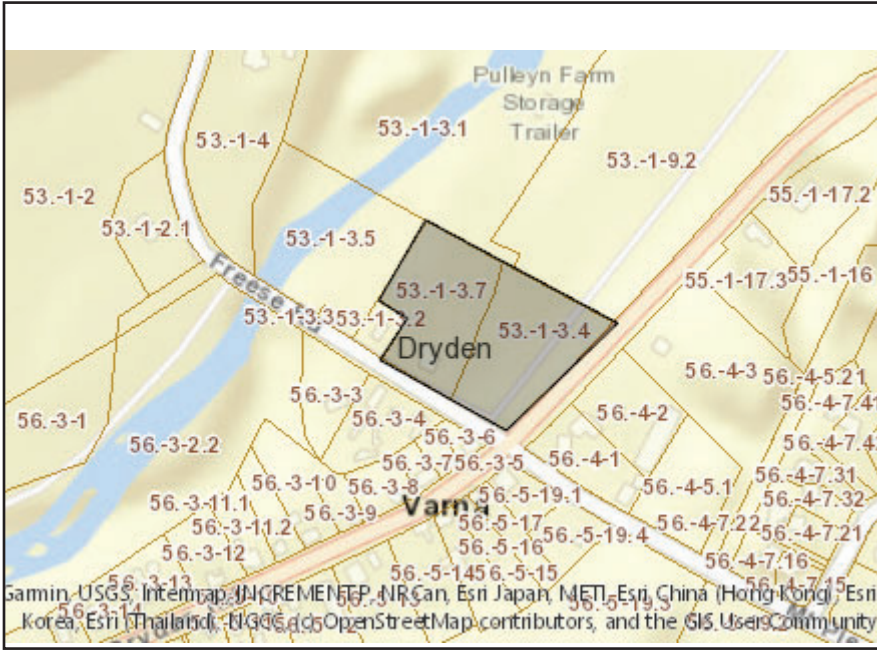

Disclaimer: The EAF Mapper is a screening tool intended to assist project sponsors and reviewing agencies in preparing an environmental assessment form (EAF). Not all questions asked in the EAF are answered by the EAF Mapper. Additional information on any EAF question can be obtained by consulting the EAF Workbooks. Although the EAF Mapper provides the most up-to-date digital data available to DEC, you may also need to contact local or other data sources in order to obtain data not provided by the Mapper. Digital data is not a substitute for agency determinations.



B.i.i [Coastal or Waterfront Area]	No
B.i.ii [Local Waterfront Revitalization Area]	No
C.2.b. [Special Planning District]	Digital mapping data are not available or are incomplete. Refer to EAF Workbook.
E.1.h [DEC Spills or Remediation Site - Potential Contamination History]	Digital mapping data are not available or are incomplete. Refer to EAF Workbook.
E.1.h.i [DEC Spills or Remediation Site - Listed]	Digital mapping data are not available or are incomplete. Refer to EAF Workbook.
E.1.h.i [DEC Spills or Remediation Site - Environmental Site Remediation Database]	Digital mapping data are not available or are incomplete. Refer to EAF Workbook.
E.1.h.iii [Within 2,000' of DEC Remediation Site]	No
E.2.g [Unique Geologic Features]	No
E.2.h.i [Surface Water Features]	No
E.2.h.ii [Surface Water Features]	Yes
E.2.h.iii [Surface Water Features]	Yes - Digital mapping information on local and federal wetlands and waterbodies is known to be incomplete. Refer to EAF Workbook.
E.2.h.v [Impaired Water Bodies]	No
E.2.i. [Floodway]	Digital mapping data are not available or are incomplete. Refer to EAF Workbook.
E.2.j. [100 Year Floodplain]	Digital mapping data are not available or are incomplete. Refer to EAF Workbook.
E.2.k. [500 Year Floodplain]	Digital mapping data are not available or are incomplete. Refer to EAF Workbook.
E.2.l. [Aquifers]	No
E.2.n. [Natural Communities]	No
E.2.o. [Endangered or Threatened Species]	No

E.2.p. [Rare Plants or Animals]	No
E.3.a. [Agricultural District]	No
E.3.c. [National Natural Landmark]	No
E.3.d [Critical Environmental Area]	No
E.3.e. [National or State Register of Historic Places or State Eligible Sites]	Yes - Digital mapping data for archaeological site boundaries are not available. Refer to EAF Workbook.
E.3.e.ii [National or State Register of Historic Places or State Eligible Sites - Name]	Eligible property:Freese Road Metal Truss Bridge, Ithaca BIN 3209800
E.3.f. [Archeological Sites]	No
E.3.i. [Designated River Corridor]	No

Section F:

1. Sewage Loading: As part of original 5 Freese Road project, a sewage load of 9,900 GPD was identified and approved by DEC as part of that project's sewer main extension which included the planned 15-3 bedroom homes plus an additional 15-3 bedroom homes as a future phase. The current proposal includes 5 2 bedroom homes, 10 3-bedroom homes for 5 Freese Road and 64 bedrooms for 9 Freese Road for a total proposed sewage load of 11,440 GPD.
2. The Applicant is not aware of any prior generation, treatment and/or disposal of hazardous wastes at the site. If contamination is discovered during construction, a remedial plan will be developed by a qualified/licensed Environmental Engineer.
3. The Applicant's target demographic includes, but is not limited to, young professionals, graduate/post-graduate students and families.
4. The rental rates for the units will be determined based on market conditions upon completion of the project.
5. The Applicant does not have an anticipated total number of tenants for the proposed units. The development provides 47 dwelling units that will be rented by the unit.
6. The Applicant intends on renting the dwelling units by the unit. If the tenant shares a bedroom within a unit, the Applicant does not plan on limiting this as part of the lease.