

September 23, 2020

**RE: Solar Photovoltaic Plants
2150 Dryden Road
Dryden-Tompkins Solar II, LLC
SWPPP Modification Report**

The Storm Water Pollution Prevention Plan for this project was submitted in June of 2017 and Revised May 2018.

The final electrical design has been designed to meet New York State Public Service Commission and the utility, New York State Electric and Gas, requirements. The final design consists of three electrical systems each with a six-pole configuration.

The access drive has been designed as a limited use pervious access road meeting NYSDEC requirements, so there will be no additional impervious surfaces added to the site. NYSEG requires that a stabilized access drive be provided to access the three sets of poles.

During the final electrical design of the project, three electrical lines were designed and it was determined that using overhead electrical lines over the creek would avoid any disturbance of the stream banks or bed. To provide NEC required clearances the poles lines must be a minimum of 30 feet apart and tree clearance must be at least 20 feet from the outside pole lines. (see figure 1) This results in a cleared width of 100 feet and a cleared area at the creek of 0.85 acres.

The Sediment and Erosion Control plan shows silt fence between the access road and the stream (see figure 2) and the existing meadow vegetation will be maintained between the pole line and the wooded streambank.

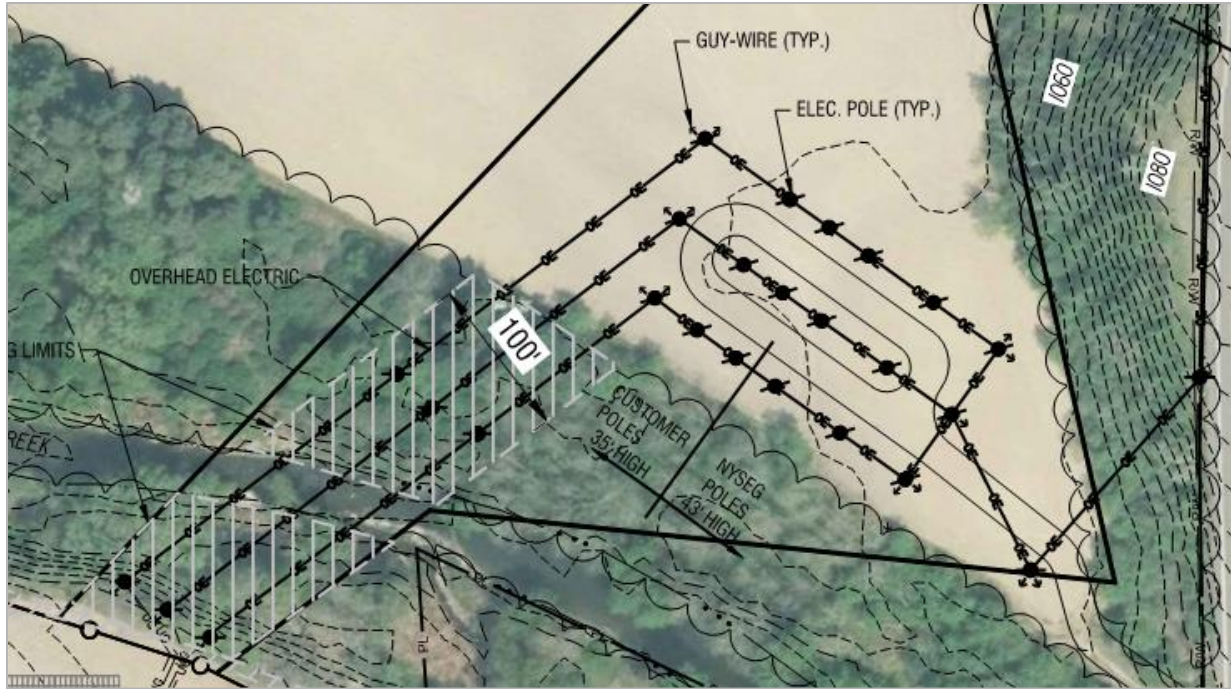

FIGURE 1

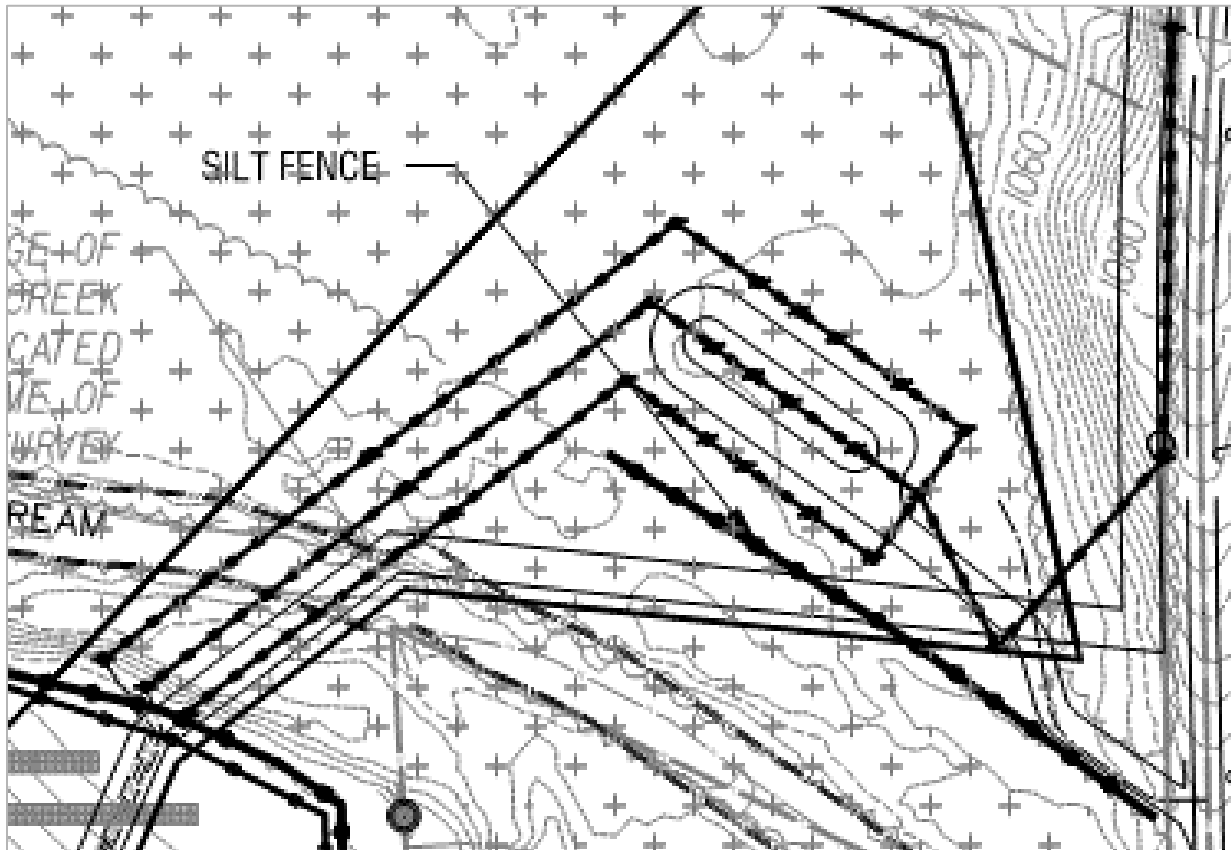

FIGURE 2