

File: I:\Engineering\Job_Files\1096-20\Drawings\1096-20_Plans.dwg, Last saved: 3/12/2020, Plot Date: 3/12/2020, By: ATISHEL, Plot Style: MARATHON_STANDARD_HALF.CTB

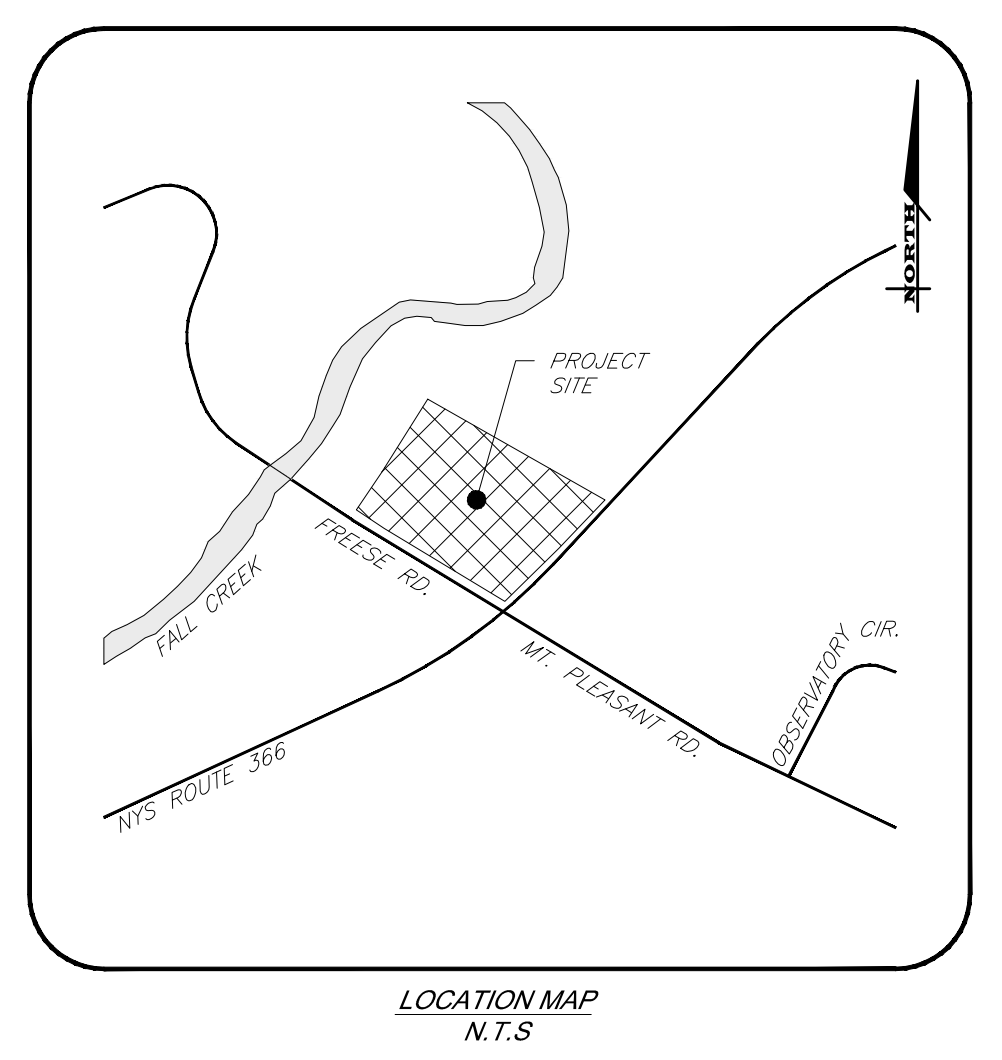
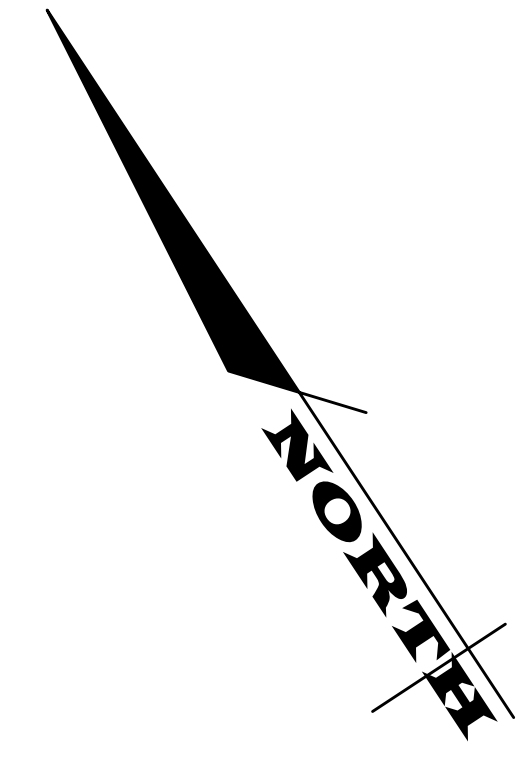
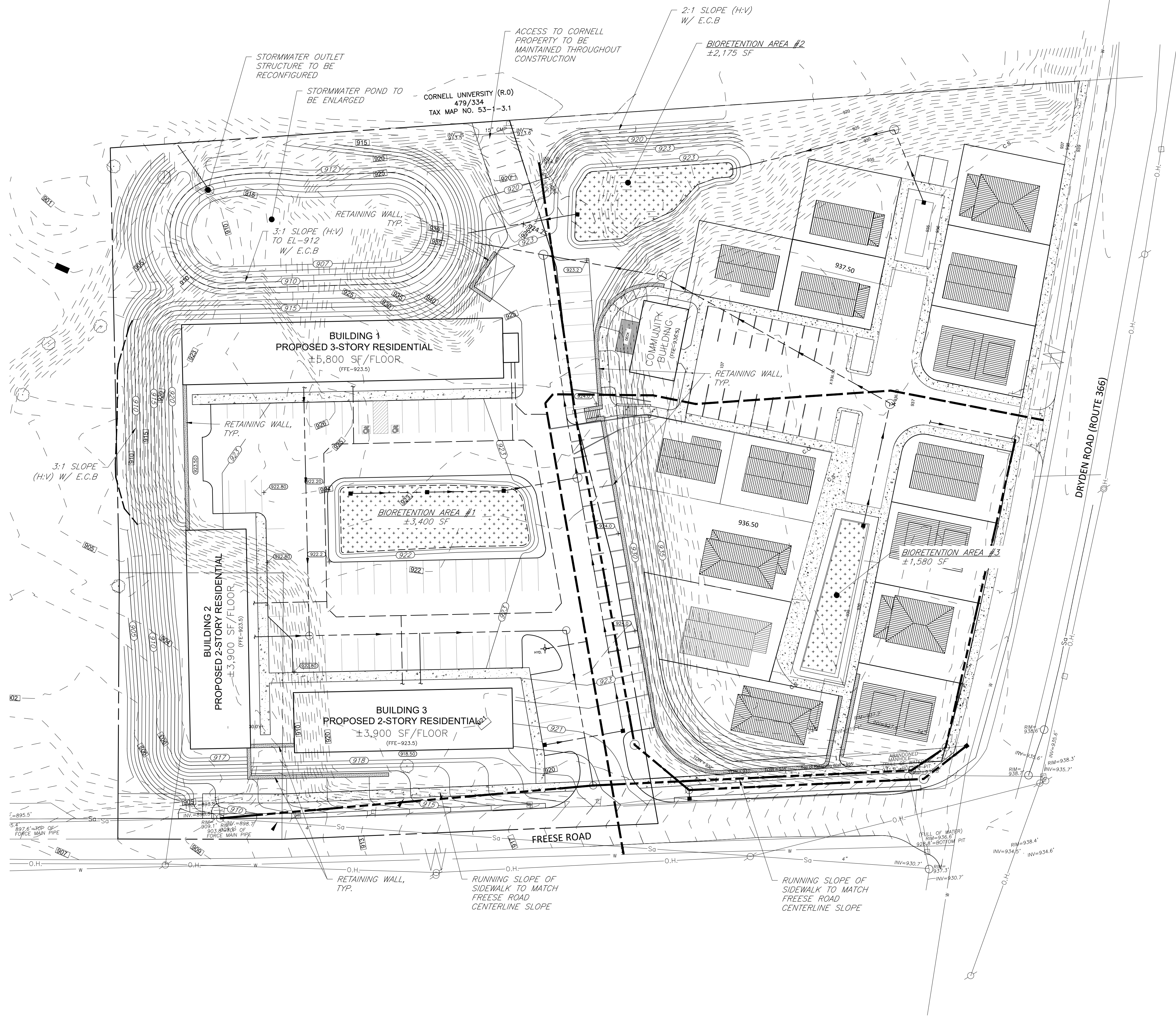

MARATHON ENGINEERING
ROCHESTER LOCATION
39 CASCADE DRIVE
ROCHESTER, NY 14614
585-458-7770
ITHACA LOCATION
840 HANSHAW RD, STE 12
ITHACA, NY 14850
607-241-2917
www.marathoneng.com

SITE DEVELOPMENT PLANS
for
MAIFLY DEVELOPMENT
INTERSECTION OF FREESE ROAD AND DRYDEN ROAD (STATE ROUTE 366)
TOWN OF DRYDEN
TOMPKINS COUNTY
STATE OF NEW YORK

JOB NO: 1096-20
SCALE: 1"=30'
DRAWN: AMF
DESIGNED: AMF
DATE: 3/11/20

REVISIONS		
DATE	BY	REVISION

THIS IS A REVISION OF NEW YORK STATE EDUCATION LAW ARTICLE 142, SECTION 2208 FOR ANY PERSON, UNDER ACTING UNDER THE DIRECTION OF A LICENSED PROFESSIONAL ENGINEER AND REGISTERED TO USE IN ANY STATE, IN THE EXERCISE OF THE DUTY OF A PROFESSIONAL ENGINEER OR ARCHITECT OR SURVEYOR IN ANY STATE, THE EXERCISE OF SUCH DUTY AND SERVICE SHALL BE HELD TO THE SAME STANDARDS AND THE NATION-WIDE BY HELD BY THIS LICENSE AND THE DATE OF SUCH REVISION, AND A SPECIFIC DESCRIPTION THEREOF.

COPYRIGHT © 2020 MARATHON ENG.
STATE OF NEW YORK
NOT FOR CONSTRUCTION
PROFESSIONAL ENGINEER
ADAM M. FISHEL

DRAWING TITLE:
**Sketch Grading,
Drainage & Erosion
Control Plan**

2 of 3
SHEET No: **C-3.0**

1096-20
JOB No: DRAWING No: