

File: I:\Engineering\Job_Files\1096-20\Drawings\1096-20 Plans.dwg, Last saved: 3/12/2020, Plot Date: 3/12/2020, Plot Style: MARATHON STANDARD HALF.CTB

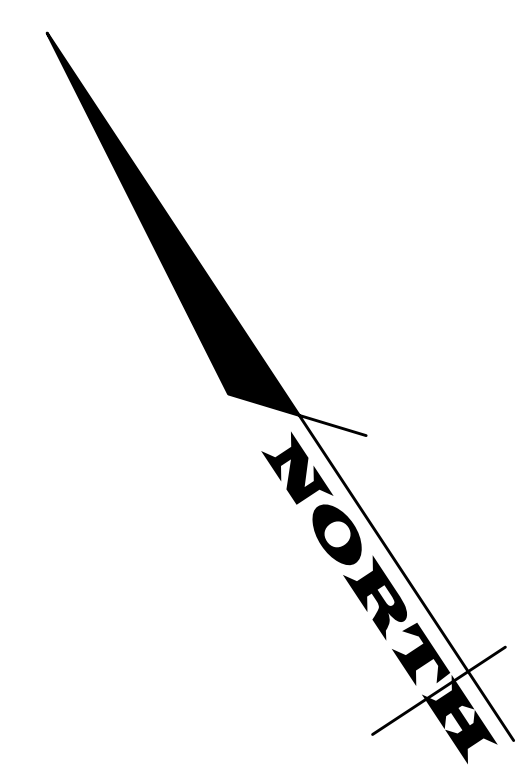
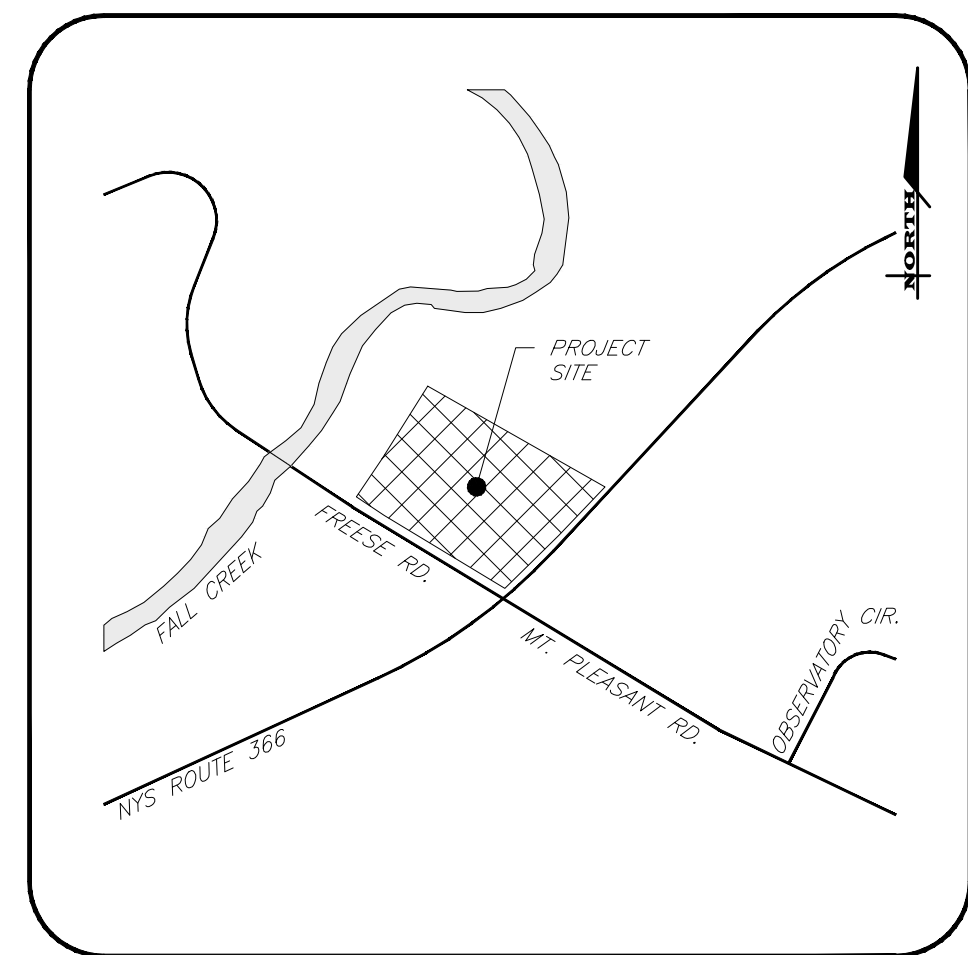
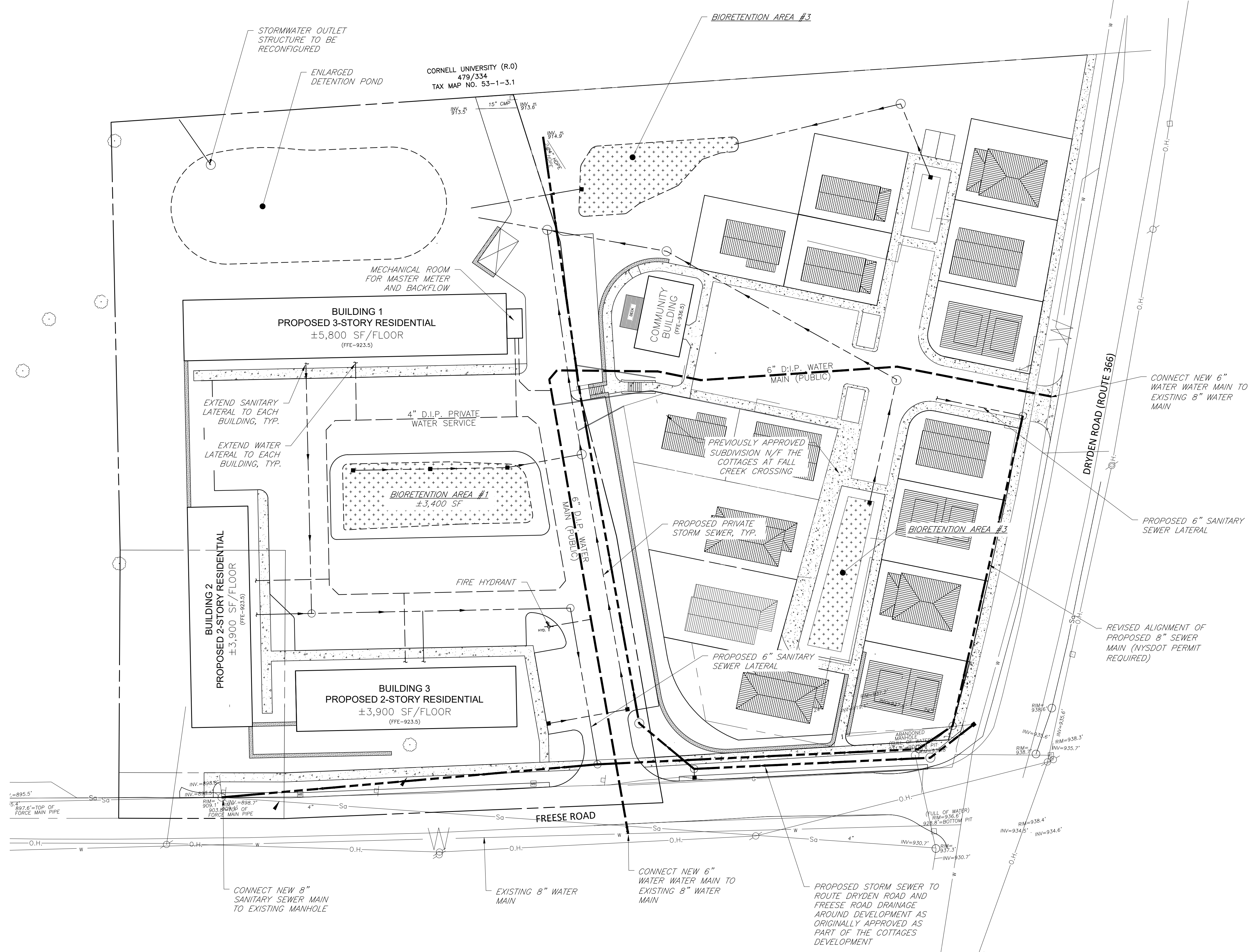

MARATHON ENGINEERING
 ROCHESTER LOCATION
 39 CASCADE DRIVE
 ROCHESTER, NY 14614
 585-458-7770
 ITHACA LOCATION
 840 HANSHAW RD, STE 12
 ITHACA, NY 14850
 607-241-2917
 www.marathoneng.com

SITE DEVELOPMENT PLANS
 for
MAIFLY DEVELOPMENT
 INTERSECTION OF FREESE ROAD AND DRYDEN ROAD (STATE ROUTE 366)
 TOWN OF DRYDEN
 TOMPKINS COUNTY
 STATE OF NEW YORK

JOB NO: 1096-20
 SCALE: 1"=30'
 DRAWN: AMF
 DESIGNED: AMF
 DATE: 3/11/20

REVISIONS		
DATE	BY	REVISION

THIS IS A SEPARATE NEW YORK STATE EDUCATION LAW ARTICLE 138 SECTION 2208 FOR ANY PERSON, UNDER ACTING UNDER THE DIRECTION OF A LICENSED PROFESSIONAL ENGINEER AND REGISTERED TO THE STATE OF NEW YORK, IN THE EXERCISE OF HIS OR HER PROFESSIONAL ENGINEERING OR SURVEYING, THE EXERCISE OF ENGINEERING OR SURVEYING SHALL BE HELD TO THE STANDARD AND THE DATE OF SUCH REGISTRATION, AND A SPECIFIC LICENSE NUMBER IS REQUIRED.

COPYRIGHT © 2020 MARATHON ENG.

NOT FOR CONSTRUCTION
 ADAM M. FISHEL

DRAWING TITLE:
Sketch Utility Plan

3 of 3	C-4.0
SHEET No:	
1096-20	DRAWING No:
JOB No:	