

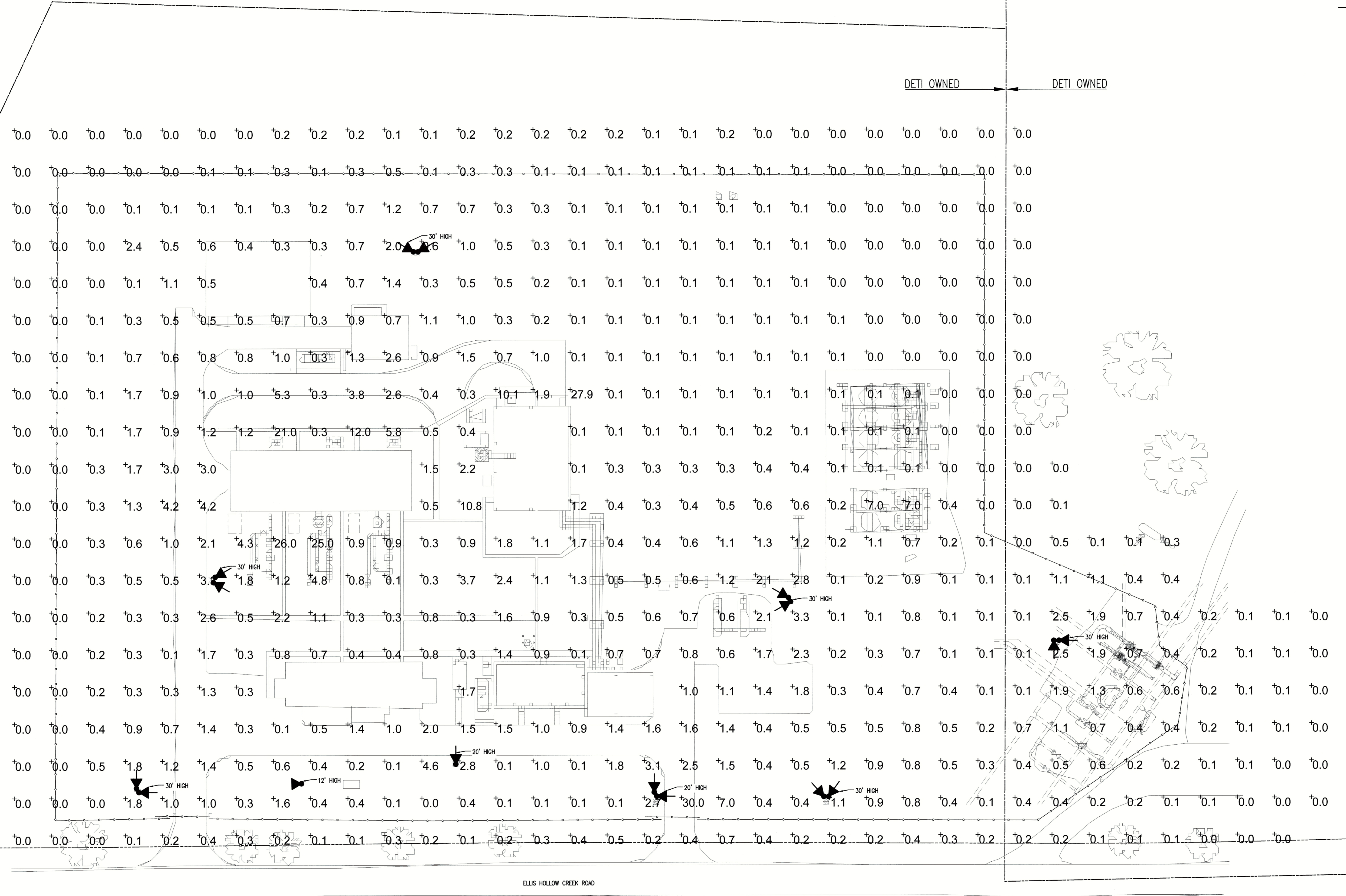

EXISTING LEGEND:  
 --- EXISTING FENCE  
 - - - - - PROPERTY LINE



LEGEND:  
 EXISTING LIGHT FIXTURES

PLAN VIEW

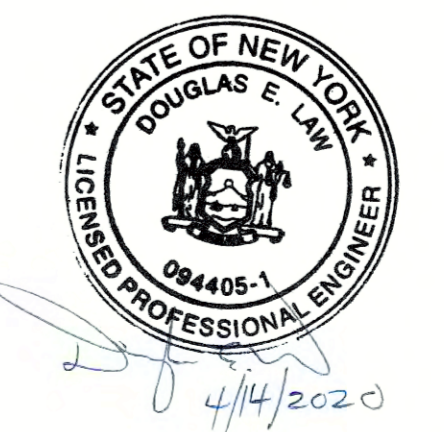
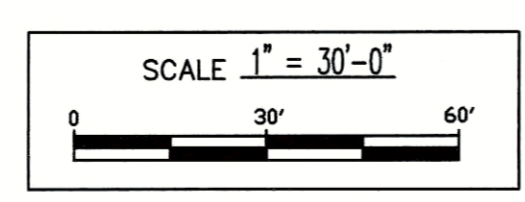

ISSUED FOR  
 4/13/2020  
 PERMITTING

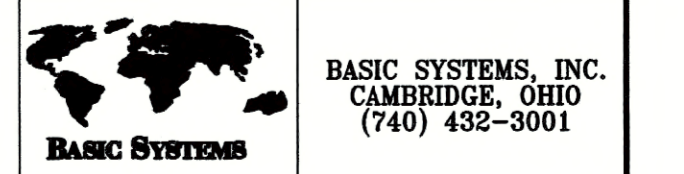

GENERAL NOTES AND COMMENTS:

SYM.	DATE	BY	REVISION INFORMATION	PROJECT/TASK	APP.	SEAL
△	04/13/20	JK	ISSUED FOR PERMITTING	78567.3.6291	5/12	
△	03/27/20	ANT	ISSUED FOR INFORMATION	78567.3.6291		
△	03/06/20	ANT	ISSUED FOR INFORMATION	78567.3.6291		

ORIGINAL CONSTRUCTION INFORMATION	
PROJECT/TASK:	61769.1.3
DRAWN:	MAB
CHECKED:	
APP. FOR BID:	
APP. FOR CONST.:	
SCALE:	1" = 30'-0"

Dominion Transmission, Inc.			
707 East Main St. Richmond, Virginia 23219			
FOR:	BORGER COMPRESSOR STATION		
TITLE:	ELECTRICAL EXISTING STATION LIGHTING PLAN		
TOWN:	DRYDEN	COUNTY:	TOMPKINS, NY
GROUP:	EL	DWG. NO.:	E7467FA
REV.:			C

# Champ FMV LED floodlights

Cl. I, Div. 2, Groups A, B, C, D  
Cl. I, Zone 2  
Cl. II, Groups E, F, G  
Cl. III & Simultaneous Presence

UL Listed  
CSA Certified  
IEC/ATEX/CE  
Type 4X; IP66

2L

2L

## The Champ FMV LED family

Champ® FMV LED floodlights are designed to provide full-spectrum, crisp, white light. Seven versions of the FMV LED are available, from 3,000 to 15,000 lumens, providing ideal solutions for a wide range of harsh and hazardous applications.



Model	Nominal lumens <sup>A</sup>	Watts	Lumens per watt	Equivalent HID luminaire	Energy savings
FMV3L	3,189	28	114	70W-100W	Up to 75% reduction in energy costs and 150,000 hours of continuous operation
FMV5L	5,183	45	115	100W-150W	
FMV7L	7,095	62	114	150W-175W	
FMV9L	9,132	79	116	175W-250W	
FMV11L	11,107	99	112	250W-400W	
FMV13L	13,100	112	117	400W	
FMV15L	15,181	131	116	450W	

### Applications:

- Oil and gas refineries, drilling rigs, petrochemical facilities, food and beverage facilities, platforms, loading docks, tunnels, outdoor wall and stanchion mounted general area lighting, and where flammable vapors, gases, ignitable dusts, fibers or flyings are present
- Locations requiring continuous and consistent light levels in extreme ambient temperatures
- Where extremely corrosive, wet, dusty, hot and/or cold conditions exist
- IP66, Type 4X, marine, wet locations and hose down environments
- Classified and hazardous locations

### Features:

- Instant illumination and restrike
- Better visibility with crisp, white light
- 0-10V dimming
- Cold temperature operation/no warm-up required
- Minimum T3C temperature rating – safely operate in the most hazardous environments and any non-hazardous location
- Serviceable drivers
- Easy installation – yoke design to mount to SFA6
- Energy-efficient technology – up to 72% energy savings over HID fixtures
- 60,000 hours of rated life at 55°C – eliminates need for frequent lamp replacement
- Contains no mercury or other hazardous substances
- Shock- and vibration-resistant solid state luminaires have no filaments or glass components that could break – greatly reduces the risk of premature failure
- Operating ambient: -40°C to 65°C (NEC only; IEC: -40°C to 55°C)
- 5 year fixture warranty

### Certifications and compliances:

- DesignLights Consortium® Qualified (some models are not DLC qualified)<sup>B</sup>

#### NEC/CEC:

- Class I, Division 2, Groups A, B, C, D; Class I, Zone 2; Class II, Groups E, F, G; Simultaneous Presence; Class III
- Type 4X, IP66

#### UL standards:

- UL844; UL1598; UL1598A; UL8750

#### CSA standard:

- CSA C22.2 No. 137

#### IEC standards:

- IECEX UL 15.0029
- Ex nA IIC T5 Gc Tamb -40°C to +40°C
- Ex nA IIC T4 Gc Tamb -40°C to +55°C
- Ex tb IIIC T65 Db Tamb -40°C to +40°C
- Ex tb IIIC T80 Db Tamb -40°C to +55°C

#### ATEX/CE:

- CE 0359 DEMKO 15 ATEX 1377
- CE 0359 DEMKO 15 ATEX 1383
- Ex II 3 G Ex nA IIC T5 Gc Tamb -40°C to +40°C
- Ex II 3 G Ex nA IIC T4 Gc Tamb -40°C to +55°C
- Ex II 2 D Ex tb IIIC T65 Db Tamb -40°C to +40°C
- Ex II 2 D Ex tb IIIC T80 Db Tamb -40°C to +55°C

### Standard materials:

- Lamp housing and adapter – die cast aluminum with Corro-free epoxy powder coat
- Lens – heat- and impact-resistant glass (standard)
- Gaskets – silicone and neoprene
- External hardware – stainless steel

### LED system:

- Cool white (5000K, 70 CRI) and warm white (3000K, 80 CRI)
- Custom designed optics – 7x6 standard; 3x3 (optional) (FMV3L-FMV11L)

### Photometrics:

- Complete photometrics can be found at [www.crouse-hinds.com/photometrics](http://www.crouse-hinds.com/photometrics)

### Effective projected area (EPA):

	FMV3L-FMV15L
Maximum EPA	1.50

### Electrical ratings:

Model	Input power (watts)	Input amps at 120-277 VAC
FMV3L	28.0 - 29.1	0.24 - 0.11
FMV5L	45.4 - 45.8	0.38 - 0.18
FMV7L	61.8 - 62.5	0.52 - 0.24
FMV9L	78.8 - 80.3	0.66 - 0.31
FMV11L	98.8 - 99.9	0.83 - 0.37
FMV13L	111.8 - 112.4	0.94 - 0.42
FMV15L	131.4 - 131.5	1.10 - 0.48

#### FMV3L-FMV15L

Voltage range, VAC	100-277V at 50/60 Hz; 347-480V at 50/60 Hz
Voltage range, VDC	108-250V
Power factor	>0.90

### Drivers:

Option	FMV3L-FMV15L
/UNV1	NEC: 100-277 VAC, 108-250 VDC; IEC: 100-252 VAC, 111-227 VDC
/UNV34	NEC: 347-480 VAC; IEC: 385-436 VAC

<sup>A</sup> Tolerance +/- 10%; at 120 VAC, 25°C ambient, 7x6 optics.

<sup>B</sup> Approved models include: FMV3L/UNV1; FMV5L/UNV1; FMV7L/UNV1; FMV9L/UNV1; FMV11L/UNV1; FMV13L/UNV1; FMV3L/UNV34; FMV5L/UNV34; FMV7L/UNV34; FMV9L/UNV34; FMV11L/UNV34; FMV13L/UNV34. 7x6 optics on all approved models; 3x3 optics not DLC approved. Refer to [www.designlights.org](http://www.designlights.org) Qualified Products List under family models for full listing details. Not all models are approved for all application categories.

# Champ FMV LED floodlights

Cl. I, Div. 2, Groups A, B, C, D  
Cl. I, Zone 2  
Cl. II, Groups E, F, G  
Cl. III, Simultaneous Presence

UL Listed  
CSA Certified  
IEC/ATEX/CE  
Type 4X; IP66

2L

2L

## Versatile design

- Can be used for outdoor or indoor applications, and for a wide range of mounting heights depending on model and light level requirement

## Smaller and lighter

- 25% smaller footprint than previous model
- 10 lbs. (4.5 kg) less weight than previous model

## Full-frame yoke

- Designed to utilize the SFA6 slipfitter and SWB6 wall mount bracket, making it ideal for retrofit or new installations



## High lumen output

- Up to 117 lumens per watt
- Up to 72% energy savings over traditional HID fixtures (compared to 400W MH)



## Multiple lens options

- Tempered clear glass lens standard
- Polycarbonate and diffused glass lens options available

## Rugged heat sink

- Heat sink designed to perform and provide maximum light levels in high ambient temperatures up to +65°C and as low as -40°C
- Thick walled castings make for a tough, rugged housing that keeps the internal driver and LED temperature down

# Champ FMV LED floodlights

Cl. I, Div. 2, Groups A, B, C, D  
 Cl. I, Zone 2  
 Cl. II, Groups E, F, G  
 Cl. III, Simultaneous Presence

UL Listed  
 CSA Certified  
 IEC/ATEX/CE  
 Type 4X; IP66

2L

2L

## Ordering information:

Part number example  
**FMV5LCY/UNV1D 76 S903**

# FMV 5L C Y /UNV1 76 S903

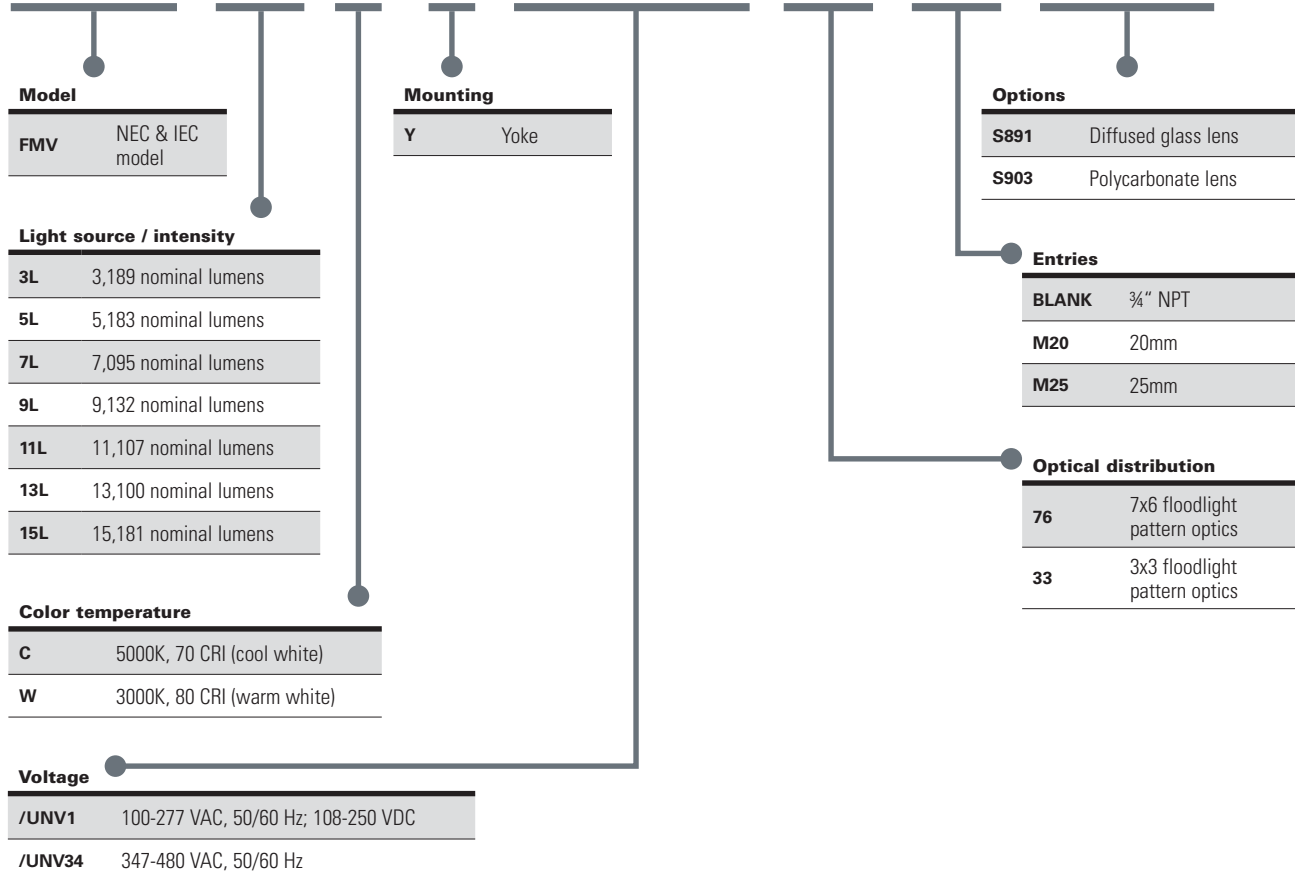

## Options:

Description	Suffix
• Diffused glass lens .....	<b>S891</b>
• Polycarbonate lens .....	<b>S903</b>

## Accessories (ordered separately):

Description	Cat. #
• Bolt-on visor .....	<b>DSV2</b>
• Bolt-on wire guard .....	<b>P62</b>
• 316 stainless steel safety cable .....	<b>SC831</b>
<i>Can be added in the field</i>	
• Floodlight slipfitter .....	<b>SFA6</b>
• Slipfitter wall mount adapter .....	<b>SWB6</b>

# Champ FMV LED floodlights

Cl. I, Div. 2, Groups A, B, C, D  
 Cl. I, Zone 2  
 Cl. II, Groups E, F, G  
 Cl. III, Simultaneous Presence

UL Listed  
 CSA Certified  
 IEC/ATEX/CE  
 Type 4X; IP66

2L

2L

## Temperature performance data:

Model	Ambient temp. °C	Class I, Div. 2	Class II, Div. 1	Simultaneous rating		ATEX 3G	ATEX 2D	Minimum wire temp. °C
				Class I, Div. 2; Div. 1	Class I, Zone 2			
FMV3L-FMV15L	40	T5	T4	T4	T5	T5	T65	90
	55	T4A	T3C	T3C	T4	T4	T80	90
	65	T4A	T3C	T3C	T4	—	—	90

## Weights and dimensions:

Model	Lbs.	Kg.	Width		Height		Depth	
			in.	mm.	in.	mm.	in.	mm.
FMV3L-FMV7L	30.70	13.90	15.50	393.70	12.00	304.80	7.00	177.80
FMV9L-FMV15L	31.80	14.40	15.50	393.70	12.00	304.80	7.00	177.80

